

What's in the box

- 1x Belong modem
- 1x Power cable
- 1x Black DSL cable*1
- 2x White Ethernet cables*2
- 1x Wi-Fi card

*1 The DSL cable is not needed for your set up.

*2 You can use the spare white Ethernet cable to connect the modem directly to a device.



Do you rely on medical, fire or security alarms that make distress calls?

Check with the manufacturer of your emergency device to see if it will work on the nbn network.



Noticed some white particles on your modem?

Don't worry, it's because we've decided to reduce our plastic and the new cardboard boxes shed a few fibres.



For best results, position your modem on a flat surface with the holes facing up and nothing covering them, or on a wall with the holes facing away from the wall.

BELONG

How to set up your Belong modem

Check your nbn box

Find your white nbn box **A** and make sure its power is turned on.

The ports you'll need to access are at the bottom of the unit. If there is a cover on your nbn box, temporarily remove it as shown. **B**

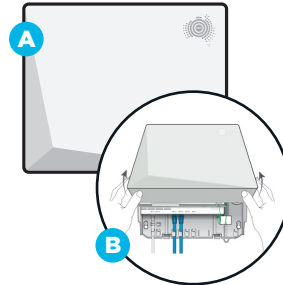

Connect modem to nbn box

Grab the white **Ethernet** cable and plug one end into **UNI-D port 1** on the nbn box (unless we tell you otherwise).

Plug the other end into the red **WAN** port on the back of your Belong modem.

Plug in your modem and turn its power on

Your modem may take up to 10 minutes before it's ready to use.

When the **Sync**, **Internet** and **Status** lights turn green the internet is ready to use.

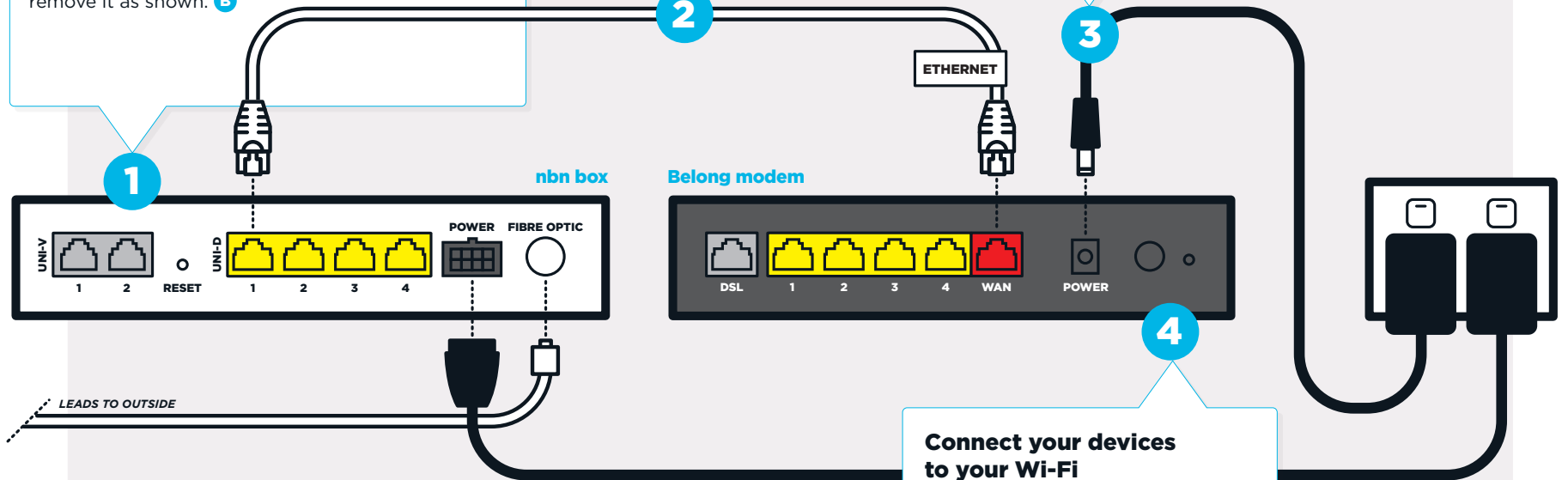

Connect your devices to your Wi-Fi

Point your smartphone camera at the QR code or enter the Wi-Fi password into your device. Both can be found on your Wi-Fi card and on the bottom of your modem.

You can also use the Ethernet cable to connect directly to a device.

Still need help?

Check your email for a step-by-step video guide.